

MARIBOR NEW

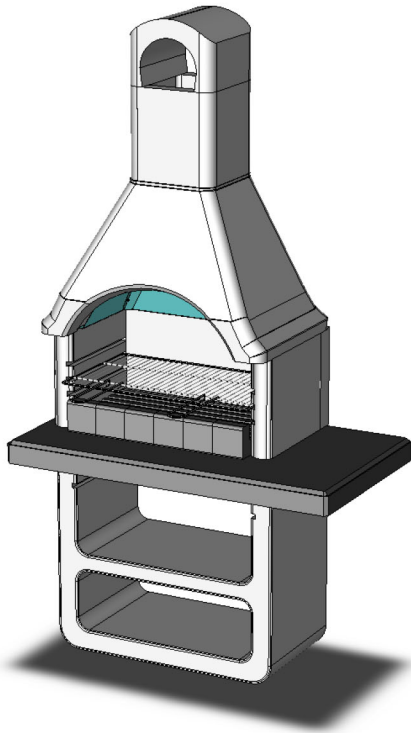

Utilizzare:



Carbonella



Legna

| | |
|---------------|-------------------------|
| Codice SAROM: | 100218 |
| Codice EAN: | 8023034042800 |
| Ingombro BBQ: | 1140x640x2125 mm |
| Peso Netto: | 367 Kg |
| Peso Lordo: | 376 Kg |
| Dim. Imballo: | 820x600x1485 mm |
| Pallet: | 820x600 mm |

Versioni Montate:

| | | |
|----------|-----------------|--|
| B | BIANCO | Code: 100218B - EAN: 8023034042817 Dim.: 1140x640x2055* - Pall.: 820x600 *comignolo smontato |
| N | NATURALE | Code: ...N - EAN: ... Dim.: ... - Pall.: ... |

Dettaglio imballo:

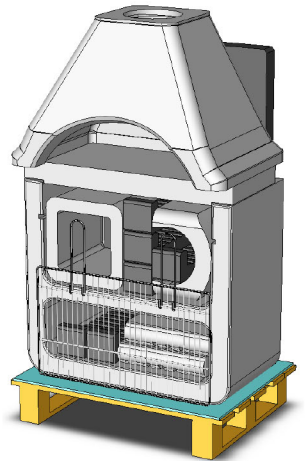

COMPONENTI INCLUSI:

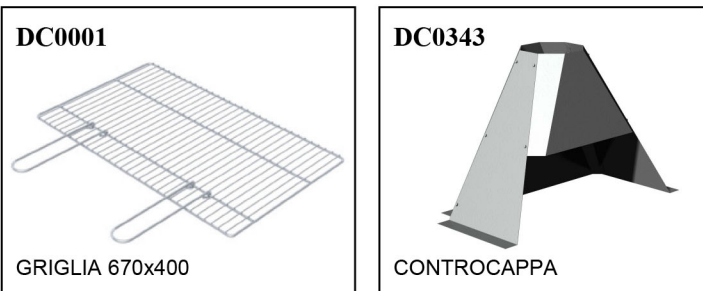

ESPLOSO:

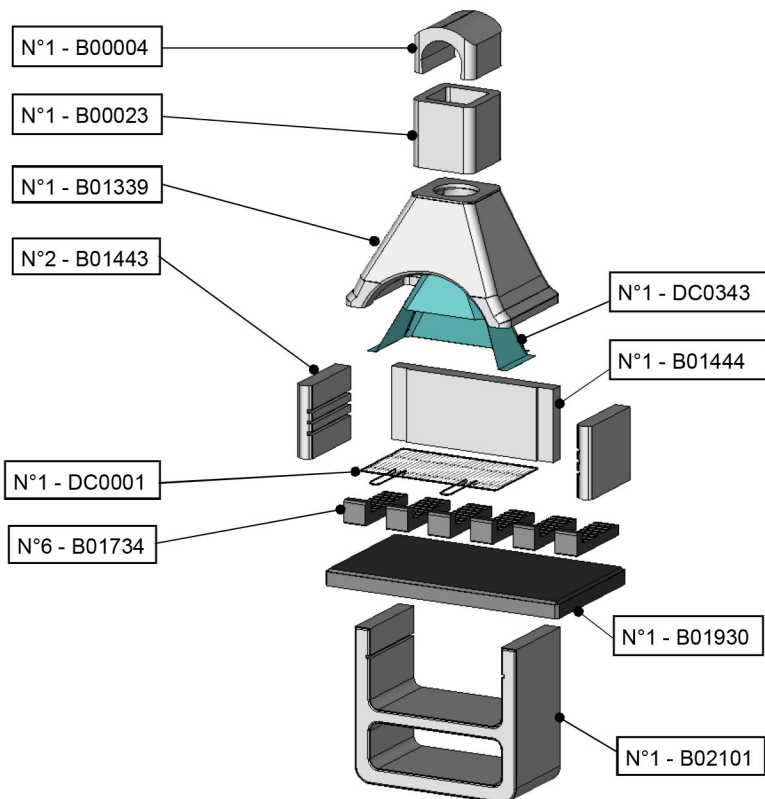

VISTA FRONTE, LATO, SEZIONE:

